

The copyright of the drawings is retained with Constructor + Thirsk Ltd and must not be copied or reproduced without the consent of the company. Figures dimensions only to be taken from this drawing. DO NOT SCALE. Dimensions and notes are given in millimetres unless otherwise stated. All dimensions and notes apply to the finished construction unless otherwise stated. All dimensions are given in millimetres unless otherwise stated. All dimensions are given in millimetres unless otherwise stated.

NOTE:

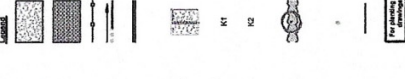

- Substation And Unit 1, Cocked Hat Farm Site Plan**
- 1. N: 420084381 / E: 420084381
  - 2. N: 420084381 / E: 420084381
  - 3. N: 420084381 / E: 420084381
  - 4. N: 420084381 / E: 420084381
  - 5. N: 420084381 / E: 420084381
  - 6. N: 420084381 / E: 420084381
  - 7. N: 420084381 / E: 420084381
  - 8. N: 420084381 / E: 420084381
  - 9. N: 420084381 / E: 420084381
  - 10. N: 420084381 / E: 420084381
  - 11. N: 420084381 / E: 420084381
  - 12. N: 420084381 / E: 420084381
  - 13. N: 420084381 / E: 420084381

Code	Unit 13-15 (relocated at 1-6)	15.03.20	MW MW
Code	Unit 16 (relocated at 1-6)	15.03.20	MW MW
Code	Unit 17 (relocated at 1-6)	15.03.20	MW MW
Code	Unit 18 (relocated at 1-6)	15.03.20	MW MW
Code	Unit 19 (relocated at 1-6)	15.03.20	MW MW
Code	Unit 20 (relocated at 1-6)	15.03.20	MW MW
Code	Unit 21 (relocated at 1-6)	15.03.20	MW MW
Code	Unit 22 (relocated at 1-6)	15.03.20	MW MW
Code	Unit 23 (relocated at 1-6)	15.03.20	MW MW
Code	Unit 24 (relocated at 1-6)	15.03.20	MW MW
Code	Unit 25 (relocated at 1-6)	15.03.20	MW MW
Code	Unit 26 (relocated at 1-6)	15.03.20	MW MW
Code	Unit 27 (relocated at 1-6)	15.03.20	MW MW
Code	Unit 28 (relocated at 1-6)	15.03.20	MW MW
Code	Unit 29 (relocated at 1-6)	15.03.20	MW MW
Code	Unit 30 (relocated at 1-6)	15.03.20	MW MW
Code	Unit 31 (relocated at 1-6)	15.03.20	MW MW
Code	Unit 32 (relocated at 1-6)	15.03.20	MW MW
Code	Unit 33 (relocated at 1-6)	15.03.20	MW MW
Code	Unit 34 (relocated at 1-6)	15.03.20	MW MW
Code	Unit 35 (relocated at 1-6)	15.03.20	MW MW
Code	Unit 36 (relocated at 1-6)	15.03.20	MW MW
Code	Unit 37 (relocated at 1-6)	15.03.20	MW MW
Code	Unit 38 (relocated at 1-6)	15.03.20	MW MW
Code	Unit 39 (relocated at 1-6)	15.03.20	MW MW
Code	Unit 40 (relocated at 1-6)	15.03.20	MW MW
Code	Unit 41 (relocated at 1-6)	15.03.20	MW MW
Code	Unit 42 (relocated at 1-6)	15.03.20	MW MW
Code	Unit 43 (relocated at 1-6)	15.03.20	MW MW
Code	Unit 44 (relocated at 1-6)	15.03.20	MW MW
Code	Unit 45 (relocated at 1-6)	15.03.20	MW MW
Code	Unit 46 (relocated at 1-6)	15.03.20	MW MW
Code	Unit 47 (relocated at 1-6)	15.03.20	MW MW
Code	Unit 48 (relocated at 1-6)	15.03.20	MW MW
Code	Unit 49 (relocated at 1-6)	15.03.20	MW MW
Code	Unit 50 (relocated at 1-6)	15.03.20	MW MW
Code	Unit 51 (relocated at 1-6)	15.03.20	MW MW
Code	Unit 52 (relocated at 1-6)	15.03.20	MW MW
Code	Unit 53 (relocated at 1-6)	15.03.20	MW MW
Code	Unit 54 (relocated at 1-6)	15.03.20	MW MW
Code	Unit 55 (relocated at 1-6)	15.03.20	MW MW
Code	Unit 56 (relocated at 1-6)	15.03.20	MW MW
Code	Unit 57 (relocated at 1-6)	15.03.20	MW MW
Code	Unit 58 (relocated at 1-6)	15.03.20	MW MW
Code	Unit 59 (relocated at 1-6)	15.03.20	MW MW
Code	Unit 60 (relocated at 1-6)	15.03.20	MW MW

**CONSTRUCTION**  
 Contractor: Merritee Investments Limited  
 Project: Sowerby, Thirsk Industrial Development  
 Proposed Site Plan  
 Drawing Title

Project No	10200	Client No	C-04
Issue No	1	Issue Date	20.03.2020
Issue Description	Final	Scale	1:250
Project Name	SOWERBY THIRSK INDUSTRIAL DEVELOPMENT	Plot No	10200

**CONSTRUCTOR + THIRSK ARCHITECTS**  
 Warwick  
 Birmingham  
 Manchester  
 London  
 Glasgow  
 Edinburgh  
 Bristol  
 Leeds  
 Liverpool  
 Nottingham  
 Sheffield  
 Cardiff  
 Exeter  
 Plymouth  
 Norwich  
 Reading  
 Southampton  
 Watlington  
 Worcester  
 York  
 Business Central | 2 Union Square | Central Park  
 Derlington | DL1 1GL  
 Tel: 01332 260958 | www.constructor-thirsk.com

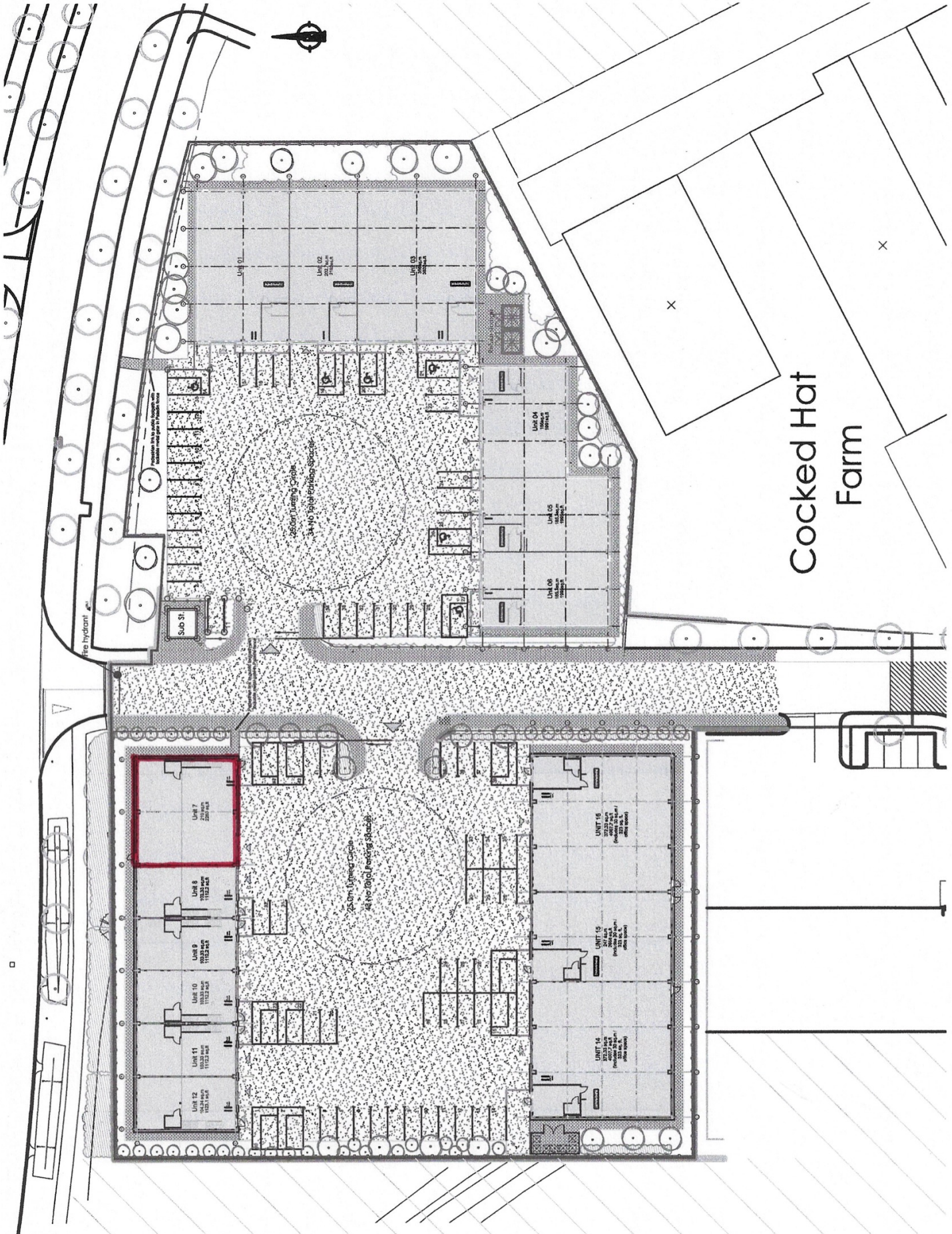

Cocked Hat Farm